

NOTRE DAME PREPARATORY SCHOOL

Modular Mobile provided permanent modular classrooms for Notre Dame Preparatory School for additional space.

THE CHALLENGE

Notre Dame Preparatory School bought a property with the hopes of moving all its campuses to one location. After renovating the buildings on the property, they were still in need of additional classroom space.



Customer Name: Notre Dame Preparatory

Project Location: Pontiac, MI

Building Type(s): Modular Classroom

Job Type: Sale

Total Sq. Ft: 13,104 sq. ft.

THE SOLUTION

To create the necessary space, our team built a single-story, 13-module addition connected to the existing building with an enclosed corridor. The building is made of 12 classrooms and shared restrooms. The exterior and interior were outfitted with materials matching and blending seamlessly with the existing buildings. The modular addition was completed in 139 days and the students could attend their new school on the first day of school.

Contact Us Today!

866.889.7777 • mobilemodular.com



BUILDING LAYOUT

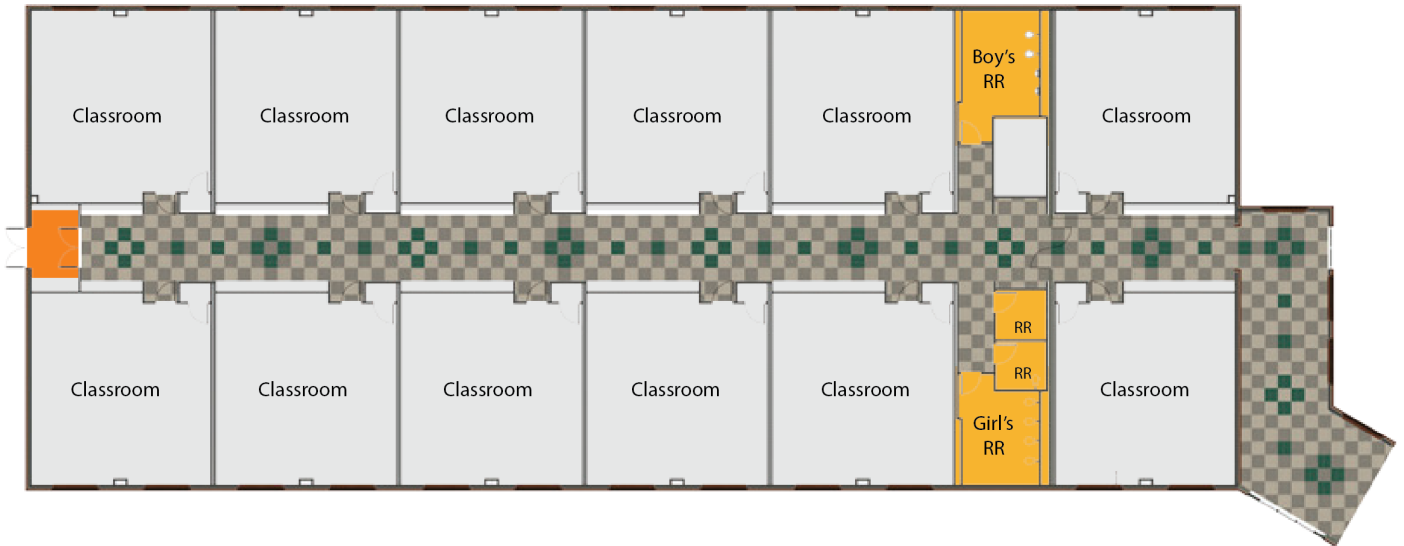

Contact Us Today!

866.889.7777 • mobilemodular.com

