

# CLAREMORE INDIAN HOSPITAL

Mobile Modular helped Claremore Indian Hospital come to a creative solution after a five-year plan for a MRI addition fell through.



## THE CHALLENGE

Following an original plan to site build an MRI addition to the Claremore Indian Hospital in Claremore, Oklahoma falling through, the hospital was looking for a creative solution. For five years they worked to find a solution and turned to modular to add the MRI as quickly as possible, while also minimizing the disruption to the patients and staff in the rest of the hospital.



**Customer Name:** Claremore Indian Hospital

**Project Location:** Claremore, OK

**Building Type(s):** Imaging Building

**Job Type:** Sale

**Total Sq. Ft:** 884 sq. ft.

## THE SOLUTION

We installed an 884-square-foot modular MRI suite at the Claremore Indian Hospital with a Toshiba Vantage 1.5 Tesla MRI. The scan room has an RF shield to isolate interference which can negatively affect image quality and magnetic shielding for safety. The installation also included state-of-the-art DDC Controls for the HVAC system to monitor and remotely adjust temperature and humidity to meet Toshiba specifications. This allows for employees to log on to a laptop remotely and adjust the temperature or humidity while monitoring trends in critical areas.

**Contact Us Today!**

866.889.7777 • [mobilemodular.com](http://mobilemodular.com)



# BUILDING LAYOUT

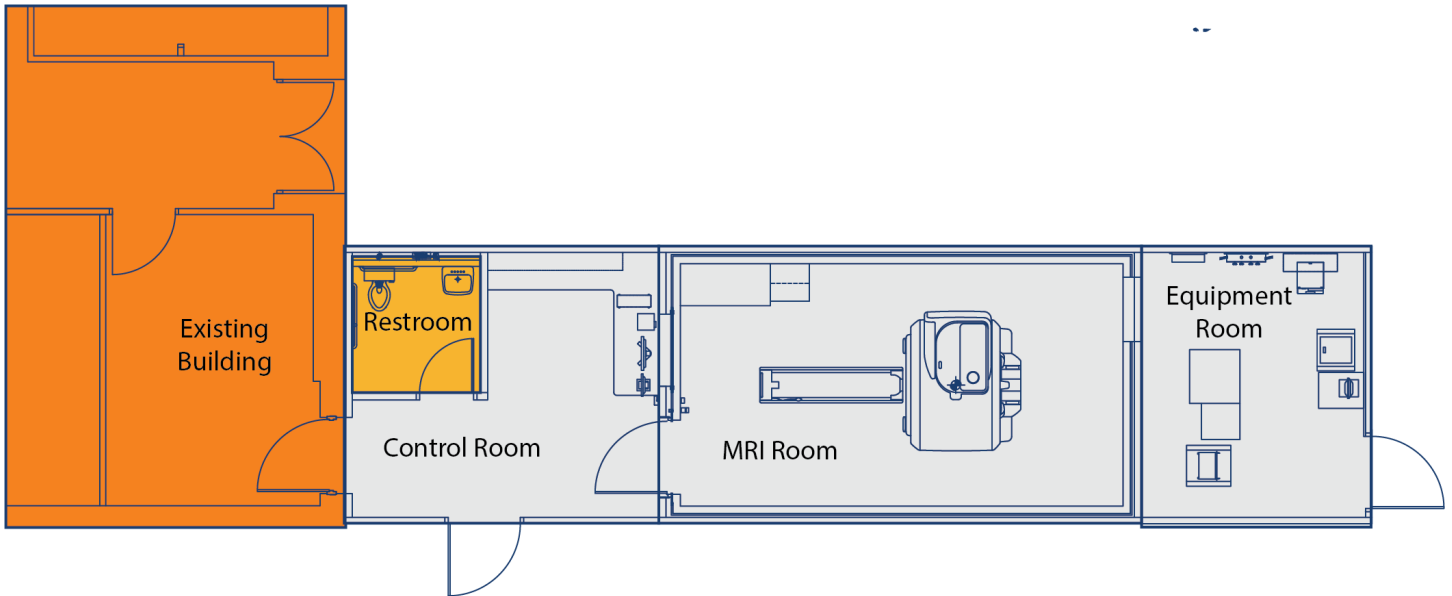

**Contact Us Today!**

866.889.7777 • [mobilemodular.com](http://mobilemodular.com)

