

TRI-VALLEY OPPORTUNITY COUNCIL

Mobile Modular provided Tri-Valley Opportunity Council an eight-classroom facility that houses infants, toddlers, and preschool children.

THE BACKGROUND

Until 2011, the Tri-Valley Opportunity Council's Head Start Child & Family Programs for the Sleepy Eye area were housed in the Sleepy Eye Elementary School. Eventually, the school district needed the leased space for their own programs, leaving Tri-Valley looking for a new facility. The district offered to work with Tri-Valley on the new facility by offering space on their property to house a new building for the Tri-Valley programs. Tri-Valley decided permanent modular construction would be the best option for their new facility. They applied for, and received, a Federal Grant to purchase a modular building. They then issued a formal RFP and interviewed the respondents.



Contact Us Today!

866.889.7777 • mobilemodular.com

Customer Name: Tri-Valley Opportunity Council

Project Location: Sleepy Eye, Minnesota

Building Type(s): Modular Classrooms

Job Type: Sale

Total Sq. Ft.: 7,920 sq. ft.

THE PROCESS

Mobile Modular team was selected to do a turnkey permanent facility for an eight-classroom building that would house infants, toddlers, and preschool children in the Head Start program. Today, Tri-Valley still occupies the building and considers it one of their best facilities.



BUILDING LAYOUT

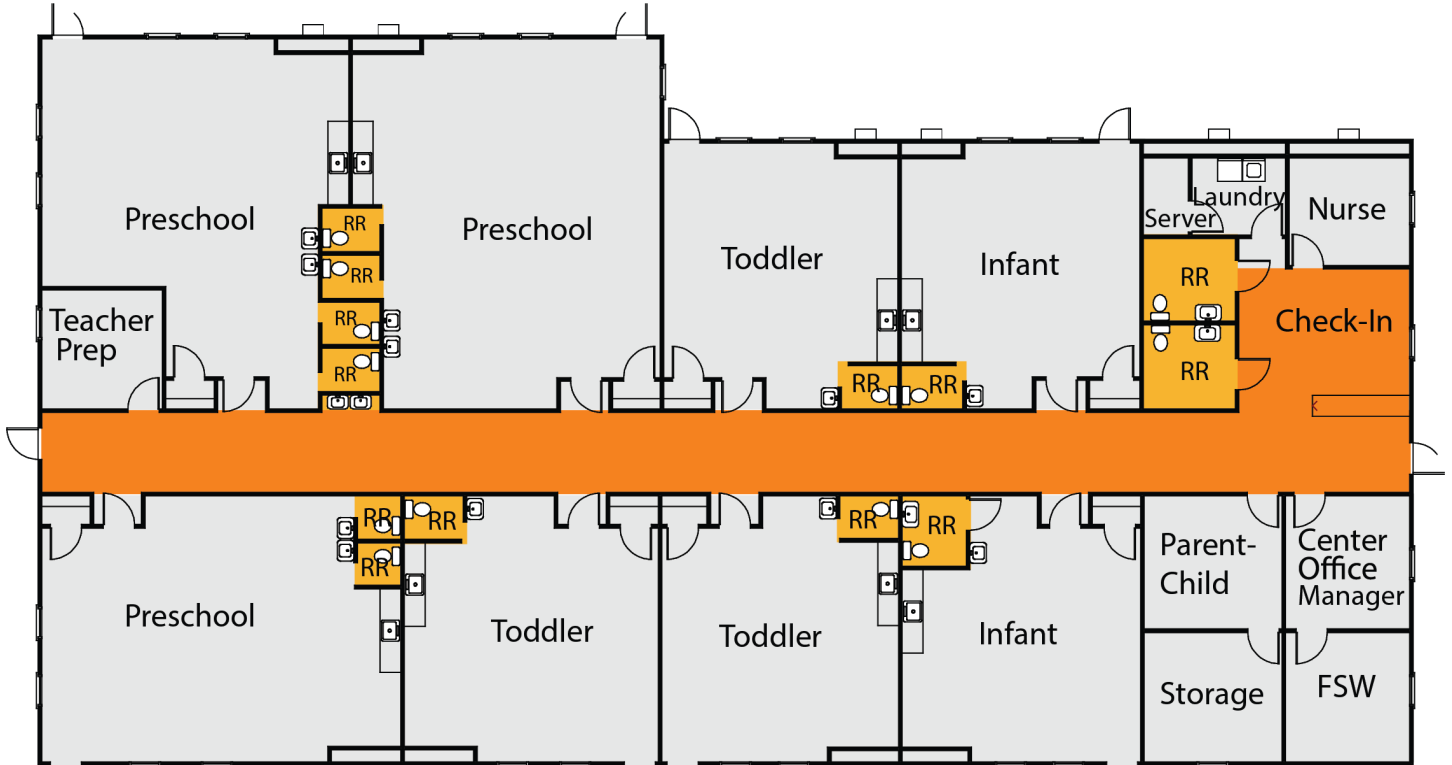

Contact Us Today!

866.889.7777 • mobilemodular.com

